

LAGMASTER PLUS™

One pole...many applications!

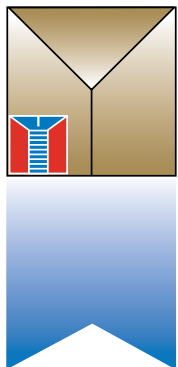

STOCK NO.	UPC NO.	DESCRIPTION	QTY. PKG.	SUGGESTED TRADE LIST PRICE PER
MLMT4	13329	Triple 4' Installation Tool 18' Ceiling	1	322.50/pkg.
MLMT6	13331	Triple 6' Installation Tool 24' Ceiling	1	372.50/pkg.



Metallics

"Growth Through Innovation"

229 Cross Street, Bristol, CT 06010

Tel 800-243-8272

Fax 800-831-9358

Email andy@metallicsonline.com

www.metallicsonline.com

LAGMASTERTM *plus*

Patent Pending

***Plug Into...
The electrician's only
multipurpose tool
for hanging...***

- + WIRE**
- + THREADED ROD**
- + SMOOTH ROD**
- + JACK CHAIN**
- + SCREWS**

***...with
interchangeable
heads!***



Metallics

"Growth Through Innovation"

LAGMASTER PLUS™

The Lagmaster Plus™ is the electrician's pole tool. The unique plug-in heads make it the most efficient tool of it's kind. It increases safety by keeping your men on the floor. Use it to install ceiling wire, jack chain, threaded rod, smooth rod and overhead screw installation. Power the pole with any 3/8" or 1/2" battery operated or corded drill.



One pole...many applications!

Choose from two (2) different adjustable length models.

- MLMTA Triple 4' (18' ceilings)
- MLMT6 Triple 6' (24' ceilings)

HANG IT UP. (wire plug)

Lagmaster Plus™ wire plug hangs 12 or 9 guage wire. No need for ladders, scaffolding or scissor lifts.

Pre-wrapped wire on eye lags require a special plug (pre-wrapped plug).



Hang Wire. Move ring into the up position with set screw

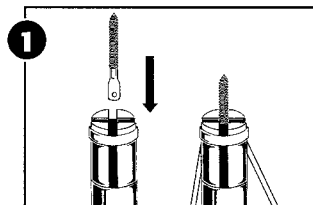

Insert the eye lag screw into secured wire plug. Insert the wire through the hole and bend the tails down.

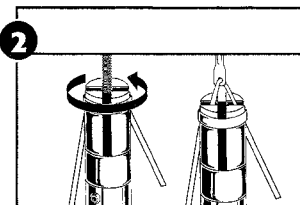

Adjust the pole to length and rotate the screw until it is seated. Pull down on the pole so that the wire is caught on the ring.

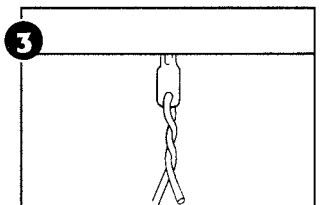

Rotate the pole again to twist the wire. Pull the wire through the plug to complete the installation.

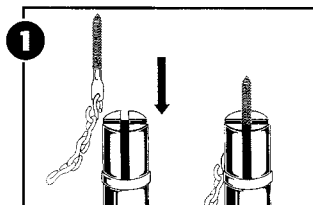

Secure a #1 1/2 "S" hook to an acoustical eye lag and to the proper size chain for your job. Insert it into the Lagmaster Plus™.

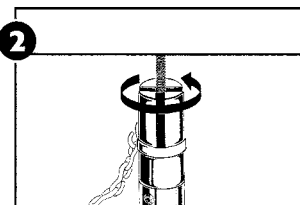

Secure the chain in the magazine so it does not whip when rotating the pole. Now rotate the eye lag screw until it is seated.

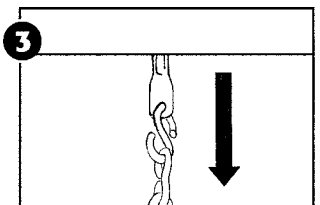

Lower the Lagmaster Plus™.



DRIVE IT HOME. (socket plugs)

Install pre-cut threaded rod from the floor! Works with 3/8" or 1/4" threaded rod up to 10' long. Gets into tight spaces, vaulted ceilings, above stairwells or through ceiling grid easily.

Lagmaster Plus™ open-end socket plug-in heads work with Sammy Super Screws® and HangerMate® screws. Special twist out feature prevents over torquing and stripout even when installing from the floor.

Consult the screw manufacturer's literature for load specs and approvals on the screws.

The Lagmaster Plus™ base is the socket for HangerMate® 3/8" rod screws. The 3/8" socket plug-in works with HangerMate® 1/4" rod screws. The 5/8" socket plug-in works with Sammy Super Screws®.

Hang Threaded Rod:

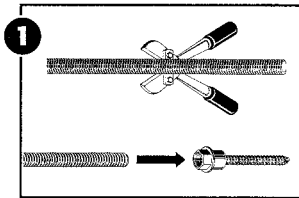

1 Cut threaded rod length and assemble to appropriate fastener.

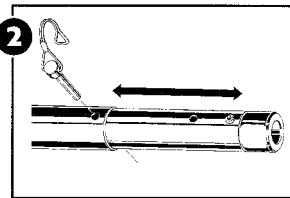

2 Adjust pole tool to length plug in the proper Lagmaster Plus™ head.

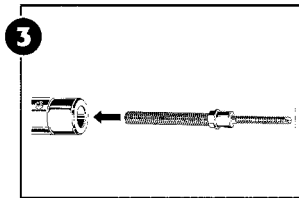

3 Load rod into Lagmaster pole tool. (The Lagmaster adjusting pin has to be 1/8" below the base or the pin may interfere with the rod.)

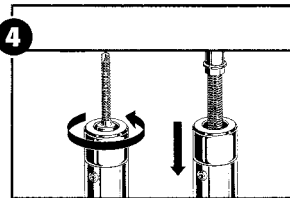

4 Install screw at proper site and pull down to remove the rod from the pole tool. The rod is now ready to receive hanger bracket.



(Patent # 5,154,104)

Turn your pole tool into a very long screwdriver. This Lagmaster Plus™ plug works with any 1/4" hex driver.

Install smooth rod with a Minerallac™ or Caddy™ spring clip assembly and screw. The Flash fastener is shown here.

Overhead Screw Applications: (1/4" hex plug)

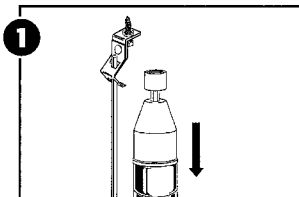

1 Plug in the Lagmaster Plus™ 1/4" hex head and insert the proper 1/4" driver. Adjust the Lagmaster pole tool to length.

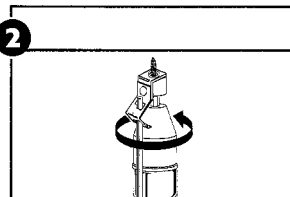

2 Push the smooth rod between the pole and the wire bale on the Lagmaster adjusting pin to keep the rod from whipping while turning in the screw for safety.

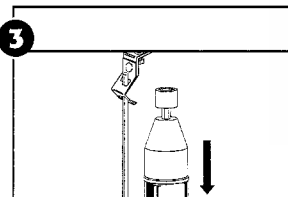

3 Turn in the screw cautiously being careful not to over torque or strip the screw. Remove the tool.

