

# Metallics

## MASTER Anchor™

*The World's Strongest Fastener™*



**[CONTRACTOR APPROVED]**

### MASTER Anchor™:

- **NEVER Loosens!**
- Installs in ALL Hollow Walls - in just minutes!
- **Rated up to 300 lbs. in drywall.**
- Handles vector forces 360°.
- Objects can be easily removed or replaced.



### 3/4" Carbide Tipped Apache 200™ Drill Bit:

- Industrial Carbide Rated at 200 Holes in Ceramic Wall Tile.
- Designed for Ceramic, Marble and Plaster.
- **Guaranteed to NEVER Walk.**
- Fits standard and cordless drills.



### Install Instructions:

Surface Preparation - Determine where to install - Drill 3/4" hole using the APACHE200. The standard MASTER Anchor is used in wall substrates up to 1.3" thick.

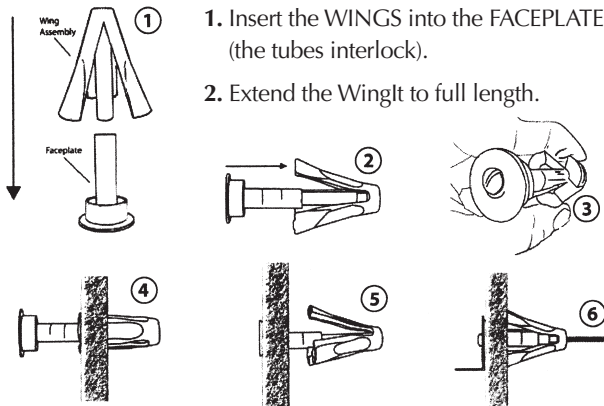

1. Insert the WINGS into the FACEPLATE (the tubes interlock).
2. Extend the WingIt to full length.

3. Compress and insert the WINGS into the holes.
4. WINGS should be FLUSH with the wall surface.
5. Pop WingIt through the hole by pushing on the Faceplate.
6. Using the enclosed 3.5" Stainless Steel Screw, attach the object to the WingIt.

NOTE: For individual mounting points where the object will be subject to considerable torque (rotational forces) - use at least TWO MASTER Anchors.

NOTE: Strength and stability are greatly affected by projection off the wall surface.

WingIts are designed to be used in vertical walls only - **DO NOT USE IN CEILINGS!**

### DRILL IT. INSTALL IT. MOUNT IT.

Fire Retardant, Structural Plastic & S/S Construction

PART #	UPC #	DESCRIPTION	QTY / PKG	SUG. TRADE LIST / PKG
MAW35SD	39696	Master Anchor with #10 x 3-1/2 SS Screw	2	\$ 9.88
MAWD34	39685	3/4" Carbide Tipped Apache Drill	1	\$ 37.14

*"Growth Through Innovation"*

### Metallics

229 Cross Street, Bristol, CT 06010  
**Tel** 800-243-8272 • **Fax** 800-831-9358  
**Email** sales@metallicsonline.com

### Metallics West

651 North Main Street, Mancos, CO 81328  
**Tel** 800-269-5183 • **Fax** 800-269-6278  
**Email** saleswest@metallicsonline.com

[www.metallicsonline.com](http://www.metallicsonline.com)